

# TECHNICAL DRAWING

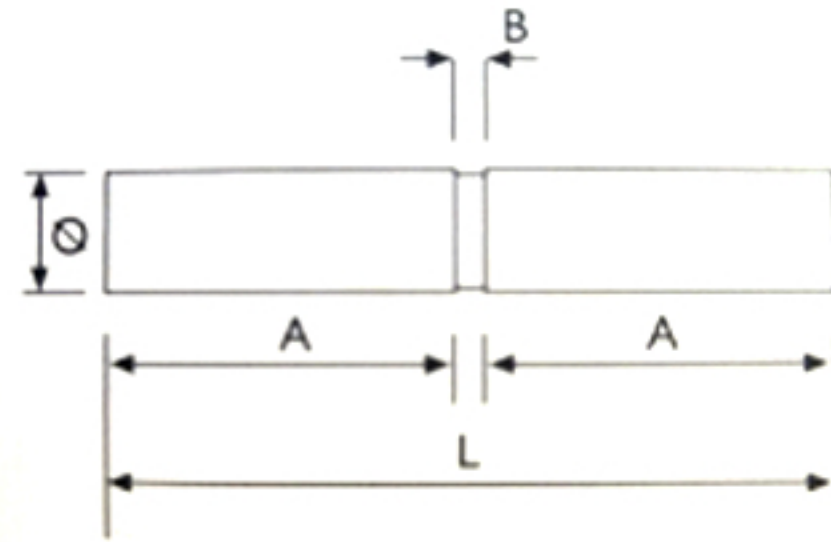

Model	Material	Part No.	mm L	in.	mm A	in.	mm B	in.	mm Φ	in.
FSSP60-10	Stainless Steel	10x60	60	2.362	29	1.142	1.5	0.059	10	0.394
FSSP60-12	Stainless Steel	12x60	70	2.755	34	1.339	1.5	0.059	12	0.472
FSSP80-12	Stainless Steel	12x80	80	3.149	39	1.535	2	0.079	12	0.472
FSSP80-14	Stainless Steel	14x80	80	3.149	39	1.535	2	0.079	14	0.551
FSSP100-14	Stainless Steel	14x100	100	3.937	49	1.929	2	0.079	14	0.551
FSSP100-16	Stainless Steel	16x100	100	3.937	49	1.929	2	0.079	16	0.63
FSSP120-16	Stainless Steel	16x120	120	4.724	59	2.323	2	0.079	16	0.63
FSSP120-20	Stainless Steel	20x120	120	4.724	59	2.323	2	0.079	20	0.787
FSSP120-22	Stainless Steel	22x120	120	4.724	59	2.323	2	0.079	22	0.866
FSSP150-25	Stainless Steel	25x150	150	5.905	74	2.913	3	0.118	25	0.984
FSSP150-30	Stainless Steel	30x150	150	5.905	74	2.913	3	0.118	30	1.181

**Tower Industry**  
YOUR MANUFACTURING BASE IN CHINA

Sales@tower-machinery.com  
www.tower-machinery.com

Flat Stainless Steel Weld on Hinge

DIMENSIONS: 60~150mm

MATERIAL: Stainless steel

FINISH: No