

TECHNICAL DRAWING

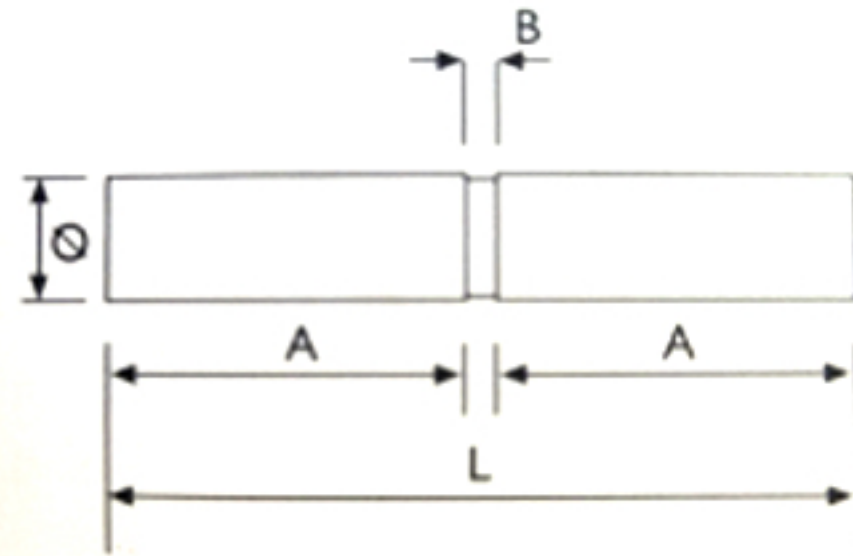

Model	Material	Part No.	mm	L	in.	mm	A	in.	mm	B	in.	mm	Φ	in.
FSP60-10	Steel	10x60	60		2.362	29		1.142	1.5		0.059	10		0.394
FSP60-12	Steel	12x60	70		2.755	34		1.339	1.5		0.059	12		0.472
FSP80-12	Steel	12x80	80		3.149	39		1.535	2		0.079	12		0.472
FSP80-14	Steel	14x80	80		3.149	39		1.535	2		0.079	14		0.551
FSP100-14	Steel	14x100	100		3.937	49		1.929	2		0.079	14		0.551
FSP100-16	Steel	16x100	100		3.937	49		1.929	2		0.079	16		0.63
FSP120-16	Steel	16x120	120		4.724	59		2.323	2		0.079	16		0.63
FSP120-20	Steel	20x120	120		4.724	59		2.323	2		0.079	20		0.787
FSP120-22	Steel	22x120	120		4.724	59		2.323	2		0.079	22		0.866
FSP150-25	Steel	25x150	150		5.905	74		2.913	3		0.118	25		0.984
FSP150-30	Steel	30x150	150		5.905	74		2.913	3		0.118	30		1.181

Tower Industry
YOUR MANUFACTURING BASE IN CHINA

Sales@tower-machinery.com
www.tower-machinery.com

Flat Steel Weld on Hinge

DIMENSIONS: 60~150mm

MATERIAL: Steel

FINISH: No